

REVISIONS				
REV	ECN	DESCRIPTION	DATE	BY
D2	06-0521	REVISED AND REDRAWN	8/14/06	DS

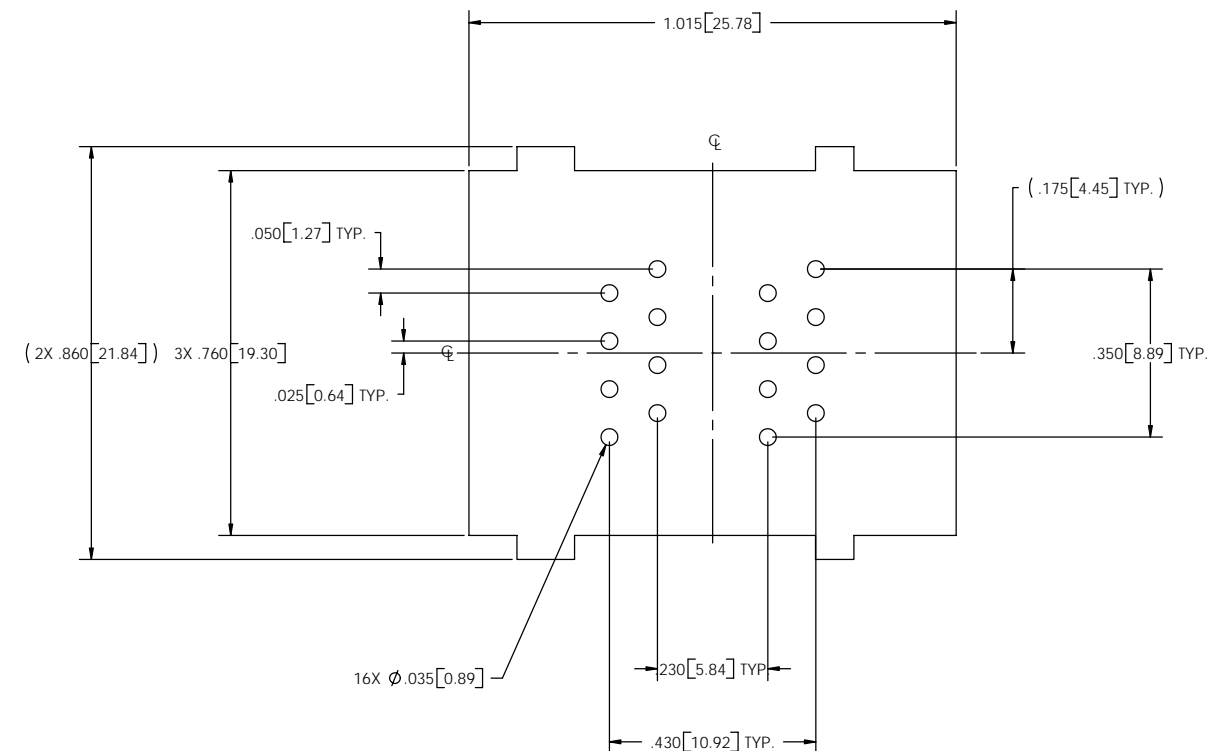

FOOTPRINT LOOKING DOWN THRU THE PART

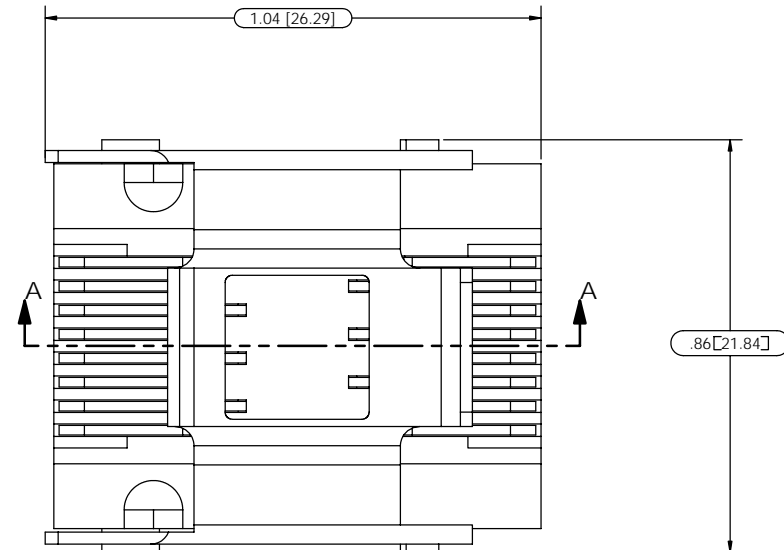
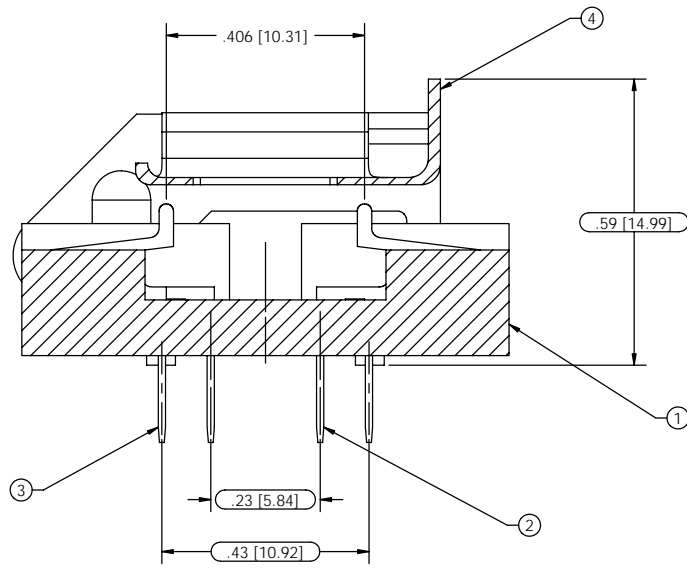

SECTION A-A  
SCALE 5 : 1

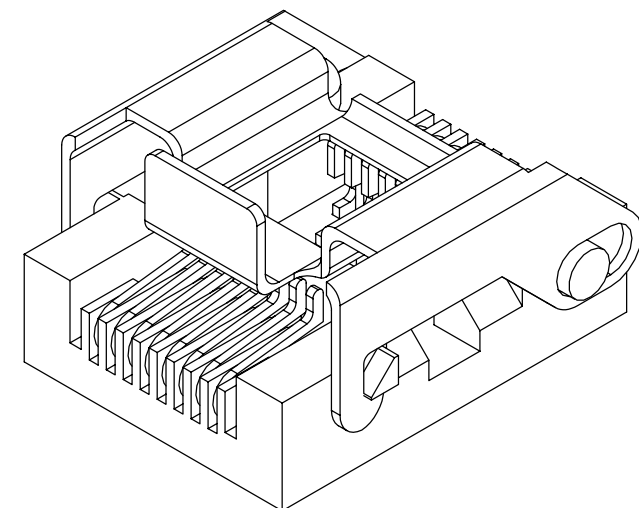
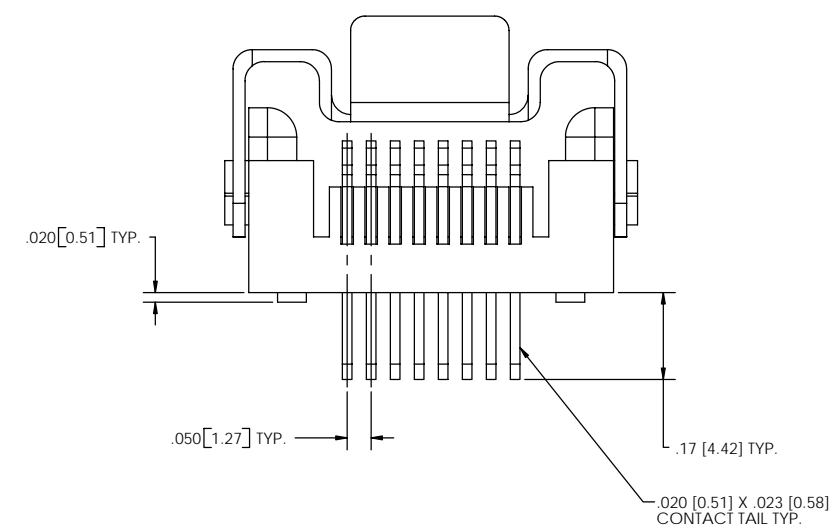

1. QUALIFY LATCH PER QAI-9

ITEM NO.	QTY.	PART NUMBER	DESCRIPTION
4	1	002-003-000	LATCH
3	8	031K11-XXX	CONTACT (OUTSIDE LEG)
2	8	031K11-XXX	CONTACT (INSIDE LEG)
1	1	009-090-003	BODY

LEGEND		TOLERANCES		MATERIAL	
CRITICAL	INTERPRET DRAWING IN ACCORDANCE WITH ASME Y14.5M 1994	XXX ± 0.01	XXX ± 0.003	XXX ± 0.005	XXX ± 0.005
PROJECTION	5 TOTAL NO. OF USED	ANGLE	±		

DATE	BY	DATE	BY
8/14/06	DS	8/14/06	DS

<b>D</b> THIS DOCUMENT CONTAINS PROPRIETARY INFORMATION OF UMD/WELLS-CTI. NOT TO BE USED, COPIED OR DISCLOSED WITHOUT PERMISSION. ALL RIGHTS RESERVED.	<b>Advanced Test Technologies</b> Phoenix, Arizona USA
--	---

TITLE	FLATPACK CONTACTOR
DESCRIPTION	16 LEAD .050 CNTRS.
DRAWING NUMBER	621-016XXXX
SCALE	5:1
UNITS	in [mm]
SHEET	1 OF 1